

LL33.17

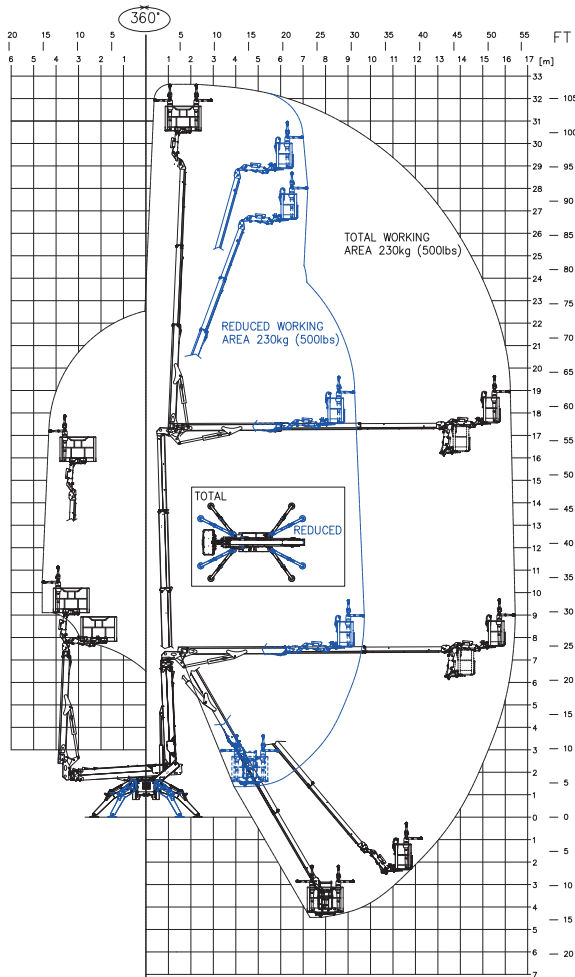

CAPACITY 230 KG
(2 persons 80x2=160 kg + tool box 70 kg)

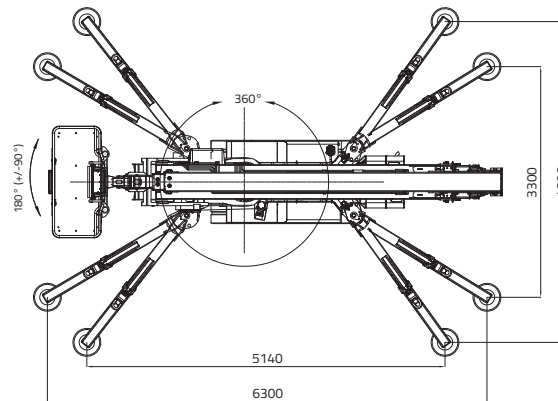
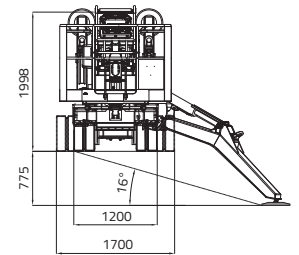
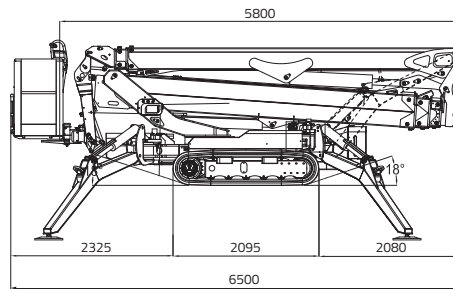

 32,60 m

 16,50 m

 6,50 m

 5,80 m

 1,99 m

 1.600 x 700 x h. 1.100 mm

 180° (+/-90°)

 16° / 28,7%

 1.200 / 1.700 mm

 5.000 daN - 4 daN/cm²

 Variable stabilization area:
4.600 x 5.140 mm (total)
3.300 x 6.300 mm (narrow)

 Automatic set up system IIIS std.

 Remote control

 GPRS-GPS

 R.A.H.M.

 Lithium-ion battery pack
7,6 kWh - Optional

 Bi-energy (Diesel + Lithium-ion
battery pack) - Optional



DIESEL ENGINE

Brand.....KUBOTA
 TypeD902 Autorev
 Pistons no. and displacement..... 898 cm³
 Max gross power
 21,6 HP - 16,1 kW @ 3200 rpm
 Electrical start..... 12 volt

LITHIUM-ION SYSTEM

Lithium-ion powered..... 7,6KWh
 Onboard battery charger
 220V or 110V+-30V 50-60 Hz
 Autonomy 4-5 h
 Recharge time on flat batteries
 4 h (indicative)
 Recharge time to 80% on flat batteries.....
 2 h (indicative)

HYDRAULIC PUMPS

Electric motor no. 2 gear pumps

TRACKED UNDERCARRIAGE

Track tensioner grease-filled
 Rollers no. per side 6 + slide

Translation speed with 2nd auto2speed:

- diesel engine 0,8 - 1,8 km/h
 - lithium system..... 0,6 - 1,3 km/h

WEIGHT MACHINE diesel engine..... 7700 kg

WEIGHT MACHINE lithium system 7740 kg

WEIGHT MACHINE bi-energy 7860 kg

MAX WIND SPEED 12,5 m/s